

## Exhaust Manifold — LH

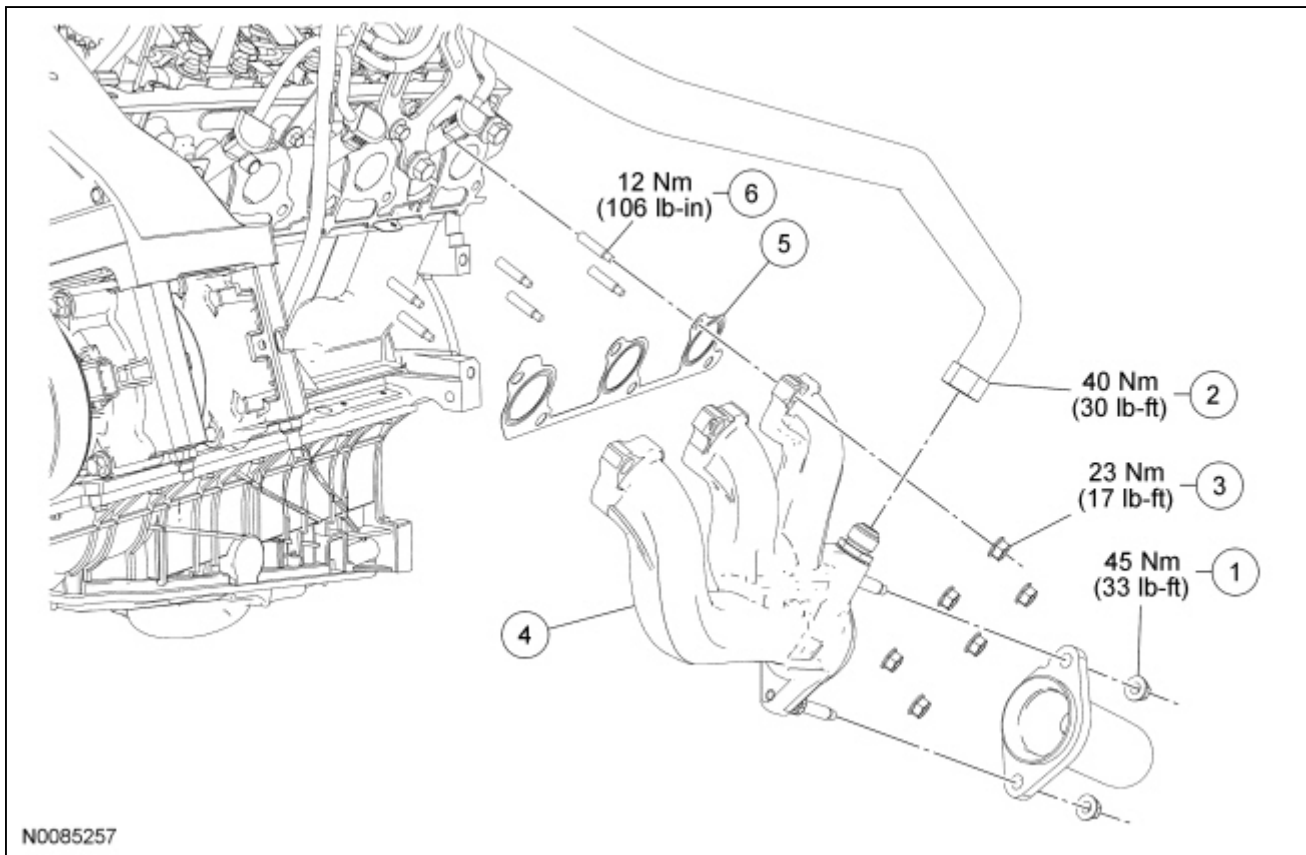

Item	Part Number	Description
1	W701706	LH catalytic converter-to-exhaust manifold nut (2 required)
2	—	EGR system module tube fitting (part of 9E649)
3	W701706	LH exhaust manifold nut (6 required)
4	9431	LH exhaust manifold
5	9448	LH exhaust manifold gasket
6	W705495	LH exhaust manifold stud (6 required)

### Removal

1. With the vehicle in NEUTRAL, position it on a hoist. For additional information, refer to [Section 100-02](#).
2. Remove the 2 catalytic converter-to-exhaust manifold nuts.
  - Discard the nuts.
3. Disconnect the EGR system module tube from the exhaust manifold.
4. Remove the 6 nuts, the LH exhaust manifold and the gasket.
  - Discard the nuts and gasket.
5. Clean and inspect the LH exhaust manifold. For additional information, refer to [Section 303-00](#).
6. Remove and discard the 6 LH exhaust manifold studs.

## Installation

1. Install the 6 new LH exhaust manifold studs.
    - Tighten to 12 Nm (106 lb-in).
  2. Install the new LH exhaust manifold gasket, manifold and 6 new nuts.
    - Tighten to 23 Nm (17 lb-ft).
  3. Connect the EGR system module tube to the exhaust manifold.
    - Tighten to 40 Nm (30 lb-ft).
  4. Install the 2 new catalytic converter-to-exhaust manifold nuts.
    - Tighten to 45 Nm (33 lb-ft).
-